

For Consideration By	Licensing Sub-Committee
Meeting Date	16 February 2023
Type of Application	Premises Licence
Address of Premises	Hart(Hilton) Hotel Lounge for Guest and Friends Hotel, 6a Ravey Street, London, EC2A 4QW
Classification	Decision
Ward(s) Affected	Hoxton East and Shoreditch
Group Director	Rickardo Hyatt

1. **Summary**

- 1.1. This is an application for a premises licence to allow authorisation for the provision of late night refreshment, regulated entertainment and sale of alcohol on Monday to Sunday.

2. **Application**

- 2.1. Shamal Overseas Shoreditch Limited has made an application for a premises licence under section 17 of the Licensing Act 2003.
- 2.2. The premises is located in the Shoreditch Special Policy Area.
- 2.3. The applicant is seeking authorisation for the following licensable activities and times:

Plays	Standard Hours: Mon 08:00-02:00 Tue 08:00-02:00 Wed 08:00-02:00 Thu 08:00-02:00 Fri 08:00-02:00 Sat 08:00-02:00 Sun 08:00-02:00
Films	Standard Hours: Mon 08:00-02:00

	<p>Tue 08:00-02:00 Wed 08:00-02:00 Thu 08:00-02:00 Fri 08:00-02:00 Sat 08:00-02:00 Sun 08:00-02:00</p>
Live Music	<p>Standard Hours:</p> <p>Mon 08:00-02:00 Tue 08:00-02:00 Wed 08:00-02:00 Thu 08:00-02:00 Fri 08:00-02:00 Sat 08:00-02:00 Sun 08:00-02:00</p>
Recorded Music	<p>Standard Hours:</p> <p>Mon 08:00-02:00 Tue 08:00-02:00 Wed 08:00-02:00 Thu 08:00-02:00 Fri 08:00-02:00 Sat 08:00-02:00 Sun 08:00-02:00</p>
Performance of Dance	<p>Standard Hours:</p> <p>Mon 08:00-02:00 Tue 08:00-02:00 Wed 08:00-02:00 Thu 08:00-02:00 Fri 08:00-02:00 Sat 08:00-02:00 Sun 08:00-02:00</p>
Late Night Refreshment	<p>Standard Hours:</p> <p>Mon 23:00-02:00 Tue 23:00-02:00 Wed 23:00-02:00 Thu 23:00-02:00 Fri 23:00-02:00 Sat 23:00-02:00 Sun 23:00-02:00</p>

Supply of Alcohol (On sales)	Standard Hours: Mon 08:00-02:00 Tue 08:00-02:00 Wed 08:00-02:00 Thu 08:00-02:00 Fri 08:00-02:00 Sat 08:00-02:00 Sun 08:00-02:00
The opening hours of the premises	Standard Hours: Mon 08:00-02:30 Tue 08:00-02:30 Wed 08:00-02:30 Thu 08:00-02:30 Fri 08:00-02:30 Sat 08:00-02:30 Sun 08:00-02:30

2.4. The application is attached as Appendix A. The applicant has proposed measures that could be converted to conditions (see paragraph 8.1 below).

3. **Current Status/History**

3.1. The premises is not currently licensed for any activity.

3.2. No temporary event notices have been given for this premises in last twelve months.

4. **Representations: Responsible Authorities**

From	Details
Environmental Health Authority (Environmental Protection)	Have confirmed no representation based on agreed conditions as set out in para 8.1
Environmental Health Authority (Environmental Enforcement) (Appendix B1)	Representation received on the grounds of The Prevention of Public Nuisance and proposed conditions as set out in para 8.1
Environmental Health Authority (Health & Safety)	No representation received
Weights and Measures (Trading Standards)	No representation received
Planning Authority (Appendix B2)	Informative
Area Child Protection Officer	No representation received

Fire Authority	Have confirmed no representation on this application
Police (Appendix B3)	Representation received on the grounds of The Prevention of Crime and Disorder and Prevention of Public Nuisance
Licensing Authority (Appendix B4)	Representation received on the grounds of The Prevention of Public Nuisance
Health Authority	No representation received

5. **Representations: Other Persons**

From	Details
None	No representations received

6. **Guidance Considerations**

- 6.1. The Licensing Authority is required to have regard to any guidance issued by the Secretary of State under the Licensing Act 2003.

7. **Policy Considerations**

- 7.1. Licensing Sub-Committee is required to have regard to the London Borough of Hackney's Statement of Licensing Policy ("the Policy) adopted by the Licensing Authority.
- 7.2. The Policy applies to applications where relevant representations have been made. With regard to this application, policies, LP1 (General Principles), LP2 (Licensing Objectives), LP3 (Core Hours) and LP10 (Special Policy Areas-Dalston and Shoreditch) are relevant.

8. **Officer Observations**

- 8.1. If the Sub-Committee is minded to approve the application, the following conditions should be applied the licence:

Supply of Alcohol(On/Both)

1. No supply of alcohol may be made under the premises licence:
 - (a) At a time when there is no designated premises supervisor in respect of the premises licence.
 - (b) At a time when the designated premises supervisor does not hold a personal licence or his personal licence is suspended.
2. Every supply of alcohol under the premises licence must be made or authorised by a person who holds a personal licence.
3. (1) The responsible person must ensure that staff on relevant premises

do not carry out, arrange or participate in any irresponsible promotions in relation to the premises.

(2) In this paragraph, an irresponsible promotion means any one or more of the following activities, or substantially similar activities, carried on for the purpose of encouraging the sale or supply of alcohol for consumption on the premises -

(a) games or other activities which require or encourage, or are designed to require or encourage, individuals to;

(i) drink a quantity of alcohol within a time limit (other than to drink alcohol sold or supplied on the premises before the cessation of the period in which the responsible person is authorised to sell or supply alcohol), or

(ii) drink as much alcohol as possible (whether within a time limit or otherwise);

(b) provision of unlimited or unspecified quantities of alcohol free or for a fixed or discounted fee to the public or to a group defined by a particular characteristic in a manner which carries a significant risk of undermining a licensing objective;

(c) provision of free or discounted alcohol or any other thing as a prize to encourage or reward the purchase and consumption of alcohol over a period of 24 hours or less in a manner which carries a significant risk of undermining a licensing objective;

(d) selling or supplying alcohol in association with promotional posters or flyers on, or in the vicinity of, the premises which can reasonably be considered to condone, encourage or glamorise anti-social behaviour or to refer to the effects of drunkenness in any favourable manner.

(e) dispensing alcohol directly by one person into the mouth of another (other than where that other person is unable to drink without assistance by reason of a disability).

4. The responsible person must ensure that free potable water is provided on request to customers where it is reasonably available.
5. 5.1. The premises licence holder or club premises certificate holder must ensure that an age verification policy is adopted in respect of the premises in relation to the sales or supply of alcohol.
5.2 The designated premises supervisor in relation to the premises licences must ensure that the supply of alcohol at the premises is carried on in accordance with the age verification policy.
5.3. The policy must require individuals who appear to the responsible person to be under 18 years of age (or such older age as may be specified in the policy) to produce on request, before being served alcohol, identification bearing their photograph, date of birth and either:-

- A. a holographic mark or
 - B. an ultraviolet feature.
6. The responsible person shall ensure that:
- a) where any of the following alcoholic drinks is sold or supplied for consumption on the premises (other than alcoholic drinks sold or supplied having been made up in advance ready for sale or supply in a securely closed container) it is available to customers in the following measures:
 - beer or cider: 1/2 pint;
 - gin, rum, vodka or whisky: 25ml or 35ml; and
 - still wine in a glass: 125ml; and
 - a. these measures are displayed in a menu, price list or other printed material which is available to customers on the premises; and
 - b. where a customer does not in relation to a sale of alcohol specify the quantity of alcohol to be sold, the customer is made aware that these measures are available.

Minimum Drinks Pricing

7. 7.1 A relevant person shall ensure that no alcohol is sold or supplied for consumption on or off the premises for a price which is less than the permitted price.

7.2 For the purposes of the condition set out in paragraph 7.1 above -

(a) "duty" is to be construed in accordance with the Alcoholic Liquor Duties Act 1979;

(b) "permitted price" is the price found by applying the formula - $P = D + (D \times V)$ Where -

(i) P is the permitted price,

(ii) D is the amount of duty chargeable in relation to the alcohol as if the duty were charged on the date of the sale or supply of the alcohol, and

(c) V is the rate of value added tax chargeable in relation to the alcohol as if the value added tax were charged on the date of the sale or supply of the alcohol;

(d) "relevant person" means, in relation to premises in respect of which there is in force a premises licence -

(i) the holder of the premises licence,

(ii) the designated premises supervisor (if any) in respect of such a licence,

or

(iii) the personal licence holder who makes or authorises a supply of alcohol under such a licence;

(e) "relevant person" means, in relation to premises in respect of which there is in force a club premises certificate, any member or officer of the club present on the premises in a capacity which enables the member or officer to prevent the supply in question; and

(f) "value added tax" means value added tax charged in accordance with the Value Added Tax Act 1994.

7.3 Where the permitted price given by Paragraph 8.2(b) above would (apart from this paragraph) not be a whole number of pennies, the price given by that sub-paragraph shall be taken to be the price actually given by that sub- paragraph rounded up to the nearest penny.

7.4 (1) Sub-paragraph 7.4(2) below applies where the permitted price given by Paragraph 7.2(b) above on a day ("the first day") would be different from the permitted price on the next day ("the second day") as a result of a change to the rate of duty or value added tax.

(2) The permitted price which would apply on the first day applies to sales or supplies of alcohol which take place before the expiry of the period of 14 days beginning on the second day.

Exhibition of Films

8. Admission of children (under 18) to the exhibition of any film must be restricted in accordance with: -
- (a) Recommendations made by the film classification body where the film classification body is specified in the licence, or
 - (b) Recommendations made by the licensing authority where the film classification body is not specified in the licence, or the relevant licensing authority has not notified the holder of the licence that this subsection applies to the film in question.

"film classification body" means person('s) designated under s4 of the Video Recordings Act 1984 (c.39).

Door Supervision

9. Each individual who is to carry out a security activity at the premises must be licensed by the Security Industry Authority.

Conditions consistent with the Operating Schedule

10. The premises shall install and maintain a comprehensive CCTV system as per the minimum requirements of a Metropolitan Police Crime Prevention Officer. All public areas and each entry and exit points will be covered enabling frontal identification of every person entering in any light condition. The CCTV system shall continually record whilst the premises is open for licensable activities and during all times when customers remain on the premises. All recordings shall be stored for a minimum period of 31 days with date and time stamping. Recordings shall be made available immediately upon the request of a Police or authorised officer.

11. There shall be a staff member from the premises who is conversant with the operation of the CCTV system on the premises at all times when the premises are open to the public. This staff member must be able to show a Police or authorised council officer recent data or footage when requested.
12. Premises to operate zero tolerance policy to drugs and comply with Hackney Police Drugs and Weapons policy where appropriate.
13. An incident log shall be kept at the premises, and made available on request to an authorised officer of the council or the police, which will record the following.
 - All crimes reported:
 - All ejections of patrons
 - Any complaints received.
 - Any incidents of disorder.
 - Seizure of drugs or offensive weapons.
 - Any faults in the CCTV system.
 - Any visit by a relevant authority or emergency service.
14. The Licensee shall ensure that all staff are fully trained and made aware of the legal requirement of businesses to comply with their responsibility as regards the disposal of waste produced from the business premises. The procedure for handling and preparing for disposal of the waste shall be in writing and displayed in a prominent place where it can be referred to at all times by staff.
15. There shall be no glass, or drinks in open containers taken outside of the premises at any time.
16. The Licensee shall ensure that any contract for general and recyclable waste disposal shall be appropriate in size to the amount of waste produced by the business. The Licensee shall maintain an adequate supply of waste receptacles provided by his registered waste carrier (refuse sacks or commercial waste bins) in order to ensure all refuse emanating from the business is always presented for collection by his waste carrier and shall not use any plain black or unidentifiable refuse sacks or any other unidentifiable or unmarked waste receptacles.
17. The Licensee's premises are situated in an area within which refuse may only be left on the public highway at certain times (time bands). If the Licensee's waste carrier cannot or does not comply by collecting the refuse within an hour after the close of any time band imposed by the waste authority, the Licensee must remove the refuse from the public highway and/or keep it within the premises until such time as their waste carrier arrives to collect the Refuse.
18. Clear prominent and legible signs should be erected asking customers to leave the area quietly; advising that CCTV system is operating and that police have unfettered access to it; and that management retain the right to search customers before permitting entry.

19. A written dispersal policy will be in place and implemented at the premises to move customers from the premises and the immediate vicinity in such a way as to cause minimum disturbance or nuisance to the neighbours.
20. Last entry to the premises shall be at midnight.
21. No unaccompanied children allowed on premises.
22. No children allowed inside the premises after 8 p.m.
23. A Challenge 25 proof of age scheme shall be operated at the premises where the only acceptable forms of identification are recognised photographic identification cards, such as a driving licence or passport.

Conditions derived from Responsible Authority representations

24. No noise shall emanate from the premises nor vibration be transmitted through the structure of the premises that gives rise to a nuisance.
25. Staff shall monitor customers smoking outside the premises on a regular basis and ensure patrons do not cause a public nuisance.
26. There shall be a documented smoking policy, as agreed with the Hackney Council Environmental Health section, implemented at the premises and a copy lodged with the Council's Licensing Unit.
27. Patrons permitted to temporarily leave and then re-enter the premises, eg. to smoke is restricted to a maximum of 5 people after 22:00 and shall not be permitted to take drinks or glass containers with them.
28. The Licensee shall ensure that all relevant staff are fully trained and made aware of the legal requirement of businesses to comply with their responsibility as regards the disposal of waste produced from the business premises. The procedure for handling and preparing for disposal of the waste shall be in writing and displayed in a prominent place where it can be referred to at all times by staff.
29. The Licensee shall ensure that any contract for general and recyclable waste disposal shall be appropriate in size to the amount of waste produced by the business. The Licensee shall maintain an adequate supply of waste receptacles provided by his registered waste carrier (refuse sacks or commercial waste bins) in order to ensure all refuse emanating from the business is always presented for collection by his waste carrier and shall not use any plain black or unidentifiable refuse sacks or any other unidentifiable or unmarked waste receptacles.
30. In order to minimise the amount of time any waste remains on the public highway in readiness for collection, the Licensee will ensure the timeframe within which it may expect its waste carrier to collect is adhered to.

31. The Licensee shall instruct members of staff to make regular checks of the area immediately outside the premises and remove any litter, bottles and glasses emanating from the premises. A final check should be made at close of business.
32. The Licensee shall provide a safe receptacle for cigarette ends to be placed outside for the use of customers, such receptacle being carefully placed so as not to cause an obstruction or trip.
33. The current trade waste agreement/duty of care waste transfer document shall be conspicuously displayed and maintained in the window of the premises where it can be conveniently seen and read by persons standing in Hart (Hilton) Lounge. This should remain unobstructed at all times and should clearly identify:-
 - the name of the registered waste carrier
 - the date of commencement of trade waste contract
 - the date of expiry of trade waste contract
 - the days and times of collection
 - the type of waste including the European Waste Code

9. Reasons for Officer Observations

- 9.1. Conditions (10) to (23) are derived from the applicant's operating schedule, conditions (24) to (27) are agreed with the Environmental Protection. Environmental Enforcement have proposed conditions (28) to (33) and applicant's operating schedule already includes conditions (28) and (29).

10. Legal Comments

- 10.1. The Council has a duty as a Licensing Authority under the Licensing Act 2003 to carry out its functions with a view to promoting the following 4 licensing objectives;
 - The Prevention of Crime and Disorder
 - Public Safety
 - Prevention of Public Nuisance
 - The Protection of Children from Harm
- 10.2. It should be noted that each of the licensing objectives have equal importance and are the only grounds upon which a relevant representation can be made and for which an application can be refused or terms and conditions attached to a licence.

11. Human Rights Act 1998 Implications

- 11.1. There are implications to;
 - **Article 6** – Right to a fair hearing
 - **Article 14** – Not to discriminate
 - Balancing: **Article 1**- Peaceful enjoyment of their possession (i.e. a licence is defined as being a possession) with **Article 8** – Right of Privacy (i.e. respect private & family life) to achieve a proportionate decision having regard to the protection of an individuals rights against the interests of the community at large.

12. **Members Decision Making**

12.1. **Option 1**

That the application be refused

12.2. **Option 2**

That the application be approved, together with any conditions or restrictions which Members consider necessary for the promotion of the Licensing objectives.

13. **Conclusion**

13.1. That Members decide on the application under the Licensing Act 2003.

Appendices:

Appendix A: Application for a premises licence and supporting documents

Appendix B: Representations from responsible authorities

Appendix C: Location map

Background documents

Licensing Act 2003

LBH Statement of Licensing Policy

Report Author	Name: Shan Uthayasangar Title: Licensing Officer Email: shan.uthayasangar@hackney.gov.uk Tel: 02083562431
Comments for the Group Director of Finance and Corporate Resources prepared by	Name Title Email Tel
Comments for the Director of Legal, Democratic and Electoral Services prepared by	Name Title Email Tel

↳ Hackney
LA01

Application for a premises licence to be granted under the Licensing Act 2003

PLEASE READ THE FOLLOWING INSTRUCTIONS FIRST

Before completing this form please read the guidance notes at the end of the form. If you are completing this form by hand please write legibly in block capitals. In all cases ensure that your answers are inside the boxes and written in black ink. Use additional sheets if necessary.

You may wish to keep a copy of the completed form for your records.

I/We Shamal Overseas Shoreditch Limited T/A Hart (Hilton) Hotel
(Insert name(s) of applicant)

apply for a premises licence under section 17 of the Licensing Act 2003 for the premises described in Part 1 below (the premises) and I/we are making this application to you as the relevant licensing authority in accordance with section 12 of the Licensing Act 2003

Part 1 – Premises details

Postal address of premises or, if none, ordnance survey map reference or description Hart (Hilton) Hotel Lounge for Guest and Friends Hotel 6a Ravey Street			
Post town	London	Postcode	EC2A 4QW

Telephone number at premises (if any)	██████████
Non-domestic rateable value of premises	£1350000

Part 2 - Applicant details

Please state whether you are applying for a premises licence as **Please tick as appropriate**

- a) an individual or individuals * please complete section (A)
- b) a person other than an individual *
 - i as a limited company/limited liability partnership please complete section (B)
 - ii as a partnership (other than limited liability) please complete section (B)
 - iii as an unincorporated association or please complete section (B)

- iv other (for example a statutory corporation) please complete section (B)
- c) a recognised club please complete section (B)
- d) a charity please complete section (B)
- e) the proprietor of an educational establishment please complete section (B)
- f) a health service body please complete section (B)
- g) a person who is registered under Part 2 of the Care Standards Act 2000 (c14) in respect of an independent hospital in Wales please complete section (B)
- ga) a person who is registered under Chapter 2 of Part 1 of the Health and Social Care Act 2008 (within the meaning of that Part) in an independent hospital in England please complete section (B)
- h) the chief officer of police of a police force in England and Wales please complete section (B)

* If you are applying as a person described in (a) or (b) please confirm (by ticking yes to one box below):

- I am carrying on or proposing to carry on a business which involves the use of the premises for licensable activities; or
- I am making the application pursuant to a
 - statutory function or
 - a function discharged by virtue of Her Majesty's prerogative

(A) INDIVIDUAL APPLICANTS (fill in as applicable)

Mr <input type="checkbox"/>	Mrs <input type="checkbox"/>	Miss <input type="checkbox"/>	Ms <input type="checkbox"/>	Other Title (for example, Rev)	
Surname			First names		
Date of birth		I am 18 years old or over <input type="checkbox"/> Please tick yes			
Nationality					
Current residential address if different from premises address					
Post town		Postcode			

Daytime contact telephone number	
E-mail address (optional)	
Where applicable (if demonstrating a right to work via the Home Office online right to work checking service), the 9-digit 'share code' provided to the applicant by that service (please see note 15 for information)	

SECOND INDIVIDUAL APPLICANT (if applicable)

Mr <input type="checkbox"/>	Mrs <input type="checkbox"/>	Miss <input type="checkbox"/>	Ms <input type="checkbox"/>	Other Title (for example, Rev)	
Surname			First names		
Date of birth		I am 18 years old or over <input type="checkbox"/> Please tick yes			
Nationality					
Current postal address if different from premises address					
Post town		Postcode			
Daytime contact telephone number					
E-mail address (optional)					
Where applicable (if demonstrating a right to work via the Home Office online right to work checking service), the 9-digit 'share code' provided to the applicant by that service (please see note 15 for information)					

(B) OTHER APPLICANTS

Please provide name and registered address of applicant in full. Where appropriate please give any registered number. In the case of a partnership or other joint venture (other than a body corporate), please give the name and address of each party concerned.

Name Shamal Overseas Shoreditch Limited
--

Address The Maltings 2 Anderson Road Bearwood Birmingham B66 4AR
Registered number (where applicable) 11922687
Description of applicant (for example, partnership, company, unincorporated association etc.) Limited Company
Telephone number (if any)
E-mail address (optional)

Part 3 Operating Schedule

When do you want the premises licence to start?

DD	MM	YYYY
0	7	0 1 2 0 2 2

If you wish the licence to be valid only for a limited period, when do you want it to end?

DD	MM	YYYY

Please give a general description of the premises (please read guidance note 1)

The premises is a hotel, the area to be licensed is a guest and friends lounge with a maximum capacity of 120 guests.
 The area has been created to enhance the experience of the guests. It is predominantly seated with water service.
 Normally no more than 30 guests standing.

If 5,000 or more people are expected to attend the premises at any one time, please state the number expected to attend.

--

What licensable activities do you intend to carry on from the premises?

(Please see sections 1 and 14 and Schedules 1 and 2 to the Licensing Act 2003)

- | Provision of regulated entertainment (please read guidance note 2) | Please tick all that apply |
|---|-------------------------------------|
| a) plays (if ticking yes, fill in box A) | <input checked="" type="checkbox"/> |
| b) films (if ticking yes, fill in box B) | <input checked="" type="checkbox"/> |
| c) indoor sporting events (if ticking yes, fill in box C) | <input type="checkbox"/> |
| d) boxing or wrestling entertainment (if ticking yes, fill in box D) | <input type="checkbox"/> |
| e) live music (if ticking yes, fill in box E) | <input checked="" type="checkbox"/> |
| f) recorded music (if ticking yes, fill in box F) | <input checked="" type="checkbox"/> |
| g) performances of dance (if ticking yes, fill in box G) | <input checked="" type="checkbox"/> |
| h) anything of a similar description to that falling within (e), (f) or (g) (if ticking yes, fill in box H) | <input type="checkbox"/> |
| Provision of late night refreshment (if ticking yes, fill in box I) | <input checked="" type="checkbox"/> |
| Supply of alcohol (if ticking yes, fill in box J) | <input checked="" type="checkbox"/> |

In all cases complete boxes K, L and M

A

Plays Standard days and timings (please read guidance note 7)			Will the performance of a play take place indoors or outdoors or both – please tick (please read guidance note 3)	Indoors	<input checked="" type="checkbox"/>
				Outdoors	<input type="checkbox"/>
Day	Start	Finish		Both	<input type="checkbox"/>
Mon	08:00	02:00	Please give further details here (please read guidance note 4)		
Tue	08:00	02:00			
Wed	08:00	02:00	State any seasonal variations for performing plays (please read guidance note 5)		
Thur	08:00	02:00			
Fri	08:00	02:00	Non-standard timings. Where you intend to use the premises for the performance of plays at different times to those listed in the column on the left, please list (please read guidance note 6)		
Sat	08:00	02:00			
Sun	08:00	02:00			

B

Films Standard days and timings (please read guidance note 7)			Will the exhibition of films take place indoors or outdoors or both – please tick (please read guidance note 3)	Indoors	<input checked="" type="checkbox"/>
				Outdoors	<input type="checkbox"/>
				Both	<input type="checkbox"/>
Day	Start	Finish			
Mon	08:00	02:00	Please give further details here (please read guidance note 4)		
Tue	08:00	02:00			
Wed	08:00	02:00	State any seasonal variations for the exhibition of films (please read guidance note 5)		
Thur	08:00	02:00			
Fri	08:00	02:00	Non-standard timings. Where you intend to use the premises for the exhibition of films at different times to those listed in the column on the left, please list (please read guidance note 6)		
Sat	08:00	02:00			
Sun	08:00	02:00			

C

Indoor sporting events Standard days and timings (please read guidance note 7)			Please give further details (please read guidance note 4)
Day	Start	Finish	
Mon			
Tue			State any seasonal variations for indoor sporting events (please read guidance note 5)
Wed			
Thur			Non-standard timings. Where you intend to use the premises for indoor sporting events at different times to those listed in the column on the left, please list (please read guidance note 6)
Fri			
Sat			
Sun			

D

Boxing or wrestling entertainments Standard days and timings (please read guidance note 7)			Will the boxing or wrestling entertainment take place indoors or outdoors or both – please tick (please read guidance note 3)		Indoors	<input type="checkbox"/>
					Outdoors	<input type="checkbox"/>
					Both	<input type="checkbox"/>
Day	Start	Finish	Please give further details here (please read guidance note 4)			
Mon						
			State any seasonal variations for boxing or wrestling entertainment (please read guidance note 5)			
Tue						
			Non-standard timings. Where you intend to use the premises for boxing or wrestling entertainment at different times to those listed in the column on the left, please list (please read guidance note 6)			
Wed						
Thur						
Fri						
Sat						
Sun						

E

Live music Standard days and timings (please read guidance note 7)			Will the performance of live music take place indoors or outdoors or both – please tick (please read guidance note 3)	Indoors	<input checked="" type="checkbox"/>
				Outdoors	<input type="checkbox"/>
				Both	<input type="checkbox"/>
Day	Start	Finish			
Mon	08:00	02:00	Please give further details here (please read guidance note 4)		
Tue	08:00	02:00			
Wed	08:00	02:00	State any seasonal variations for the performance of live music (please read guidance note 5)		
Thur	08:00	02:00			
Fri	08:00	02:00	Non-standard timings. Where you intend to use the premises for the performance of live music at different times to those listed in the column on the left, please list (please read guidance note 6)		
Sat	08:00	02:00			
Sun	08:00	02:00			

F

Recorded music Standard days and timings (please read guidance note 7)			Will the playing of recorded music take place indoors or outdoors or both – please tick (please read guidance note 3)	Indoors <input checked="" type="checkbox"/>
				Outdoors <input type="checkbox"/>
				Both <input type="checkbox"/>
Day	Start	Finish	Please give further details here (please read guidance note 4)	
Mon	08:00	02:00		
			State any seasonal variations for the playing of recorded music (please read guidance note 5)	
Tue	08:00	02:00		
			Non-standard timings. Where you intend to use the premises for the playing of recorded music at different times to those listed in the column on the left, please list (please read guidance note 6)	
Wed	08:00	02:00		
Thur	08:00	02:00		
Fri	08:00	02:00		
Sat	08:00	02:00		
Sun	08:00	02:00		

G

Performances of dance Standard days and timings (please read guidance note 7)			Will the performance of dance take place indoors or outdoors or both – please tick (please read guidance note 3)	Indoors	<input checked="" type="checkbox"/>
				Outdoors	<input type="checkbox"/>
				Both	<input type="checkbox"/>
Day	Start	Finish			
Mon	08:00	02:00	Please give further details here (please read guidance note 4)		
Tue	08:00	02:00			
Wed	08:00	02:00	State any seasonal variations for the performance of dance (please read guidance note 5)		
Thur	08:00	02:00			
Fri	08:00	02:00	Non-standard timings. Where you intend to use the premises for the performance of dance at different times to those listed in the column on the left, please list (please read guidance note 6)		
Sat	08:00	02:00			
Sun	08:00	02:00			

H

Anything of a similar description to that falling within (e), (f) or (g) Standard days and timings (please read guidance note 7)			Please give a description of the type of entertainment you will be providing		
Day	Start	Finish	Will this entertainment take place indoors or outdoors or both – please tick (please read guidance note 3)	Indoors	<input type="checkbox"/>
Mon				Outdoors	<input type="checkbox"/>
				Both	<input type="checkbox"/>
Tue			Please give further details here (please read guidance note 4)		
Wed					
Thur			State any seasonal variations for entertainment of a similar description to that falling within (e), (f) or (g) (please read guidance note 5)		
Fri					
Sat			Non-standard timings. Where you intend to use the premises for the entertainment of a similar description to that falling within (e), (f) or (g) at different times to those listed in the column on the left, please list (please read guidance note 6)		
Sun					

Late night refreshment Standard days and timings (please read guidance note 7)			Will the provision of late night refreshment take place indoors or outdoors or both – please tick (please read guidance note 3)	Indoors	<input checked="" type="checkbox"/>
				Outdoors	<input type="checkbox"/>
Day	Start	Finish		Both	<input type="checkbox"/>
Mon	23:00	02:00	Please give further details here (please read guidance note 4)		
Tue	23:00	02:00			
Wed	23:00	02:00	State any seasonal variations for the provision of late night refreshment (please read guidance note 5)		
Thur	23:00	02:00			
Fri	23:00	02:00	Non-standard timings. Where you intend to use the premises for the provision of late night refreshment at different times, to those listed in the column on the left, please list (please read guidance note 6)		
Sat	23:00	02:00			
Sun	23:00	02:00			

J

Supply of alcohol Standard days and timings (please read guidance note 7)			Will the supply of alcohol be for consumption – please tick (please read guidance note 8)	On the premises	<input checked="" type="checkbox"/>			
				Off the premises	<input type="checkbox"/>			
				Both	<input type="checkbox"/>			
Day	Start	Finish	State any seasonal variations for the supply of alcohol (please read guidance note 5)					
Mon	08:00	02:00						
Tue	08:00	02:00						
Wed	08:00	02:00						
Thur	08:00	02:00						
Fri	08:00	02:00						
Sat	08:00	02:00						
Sun	08:00	02:00						
						Non-standard timings. Where you intend to use the premises for the supply of alcohol at different times to those listed in the column on the left, please list (please read guidance note 6)		

State the name and details of the individual whom you wish to specify on the licence as designated premises supervisor (Please see declaration about the entitlement to work in the checklist at the end of the form):

Name Lina Zakzeckyte
Date of birth [REDACTED]
Address [REDACTED]
Postcode [REDACTED]
Personal licence number (if known) [REDACTED]
Issuing licensing authority (if known) [REDACTED]

K

Please highlight any adult entertainment or services, activities, other entertainment or matters ancillary to the use of the premises that may give rise to concern in respect of children (please read guidance note 9).

N/A

L

Hours premises are open to the public Standard days and timings (please read guidance note 7)			State any seasonal variations (please read guidance note 5)
Day	Start	Finish	
Mon	08:00	02:30	Non-standard timings. Where you intend the premises to be open to the public at different times from those listed in the column on the left, please list (please read guidance note 6)
Tue	08:00	02:30	
Wed	08:00	02:30	
Thur	08:00	02:30	
Fri	08:00	02:30	
Sat	08:00	02:30	
Sun	08:00	02:30	

M Describe the steps you intend to take to promote the four licensing objectives:

a) General – all four licensing objectives (b, c, d and e) (please read guidance note 10)

Please see the attached appendix 1 of conditions.

b) The prevention of crime and disorder

c) Public safety

d) The prevention of public nuisance

e) The protection of children from harm

Checklist:

Please tick to indicate agreement



- I have made or enclosed payment of the fee.
- I have enclosed the plan of the premises.
- I have sent copies of this application and the plan to responsible authorities and others where applicable.
- I have enclosed the consent form completed by the individual I wish to be designated premises supervisor, if applicable.
- I understand that I must now advertise my application.
- I understand that if I do not comply with the above requirements my application will be rejected.
- [Applicable to all individual applicants, including those in a partnership which is not a limited liability partnership, but not companies or limited liability partnerships] I have included documents demonstrating my entitlement to work in the United Kingdom or my share code issued by the Home Office online right to work checking service (please read note 15).

IT IS AN OFFENCE, UNDER SECTION 158 OF THE LICENSING ACT 2003, TO MAKE A FALSE STATEMENT IN OR IN CONNECTION WITH THIS APPLICATION. THOSE WHO MAKE A FALSE STATEMENT MAY BE LIABLE ON SUMMARY CONVICTION TO A FINE OF ANY AMOUNT.

IT IS AN OFFENCE UNDER SECTION 24B OF THE IMMIGRATION ACT 1971 FOR A PERSON TO WORK WHEN THEY KNOW, OR HAVE REASONABLE CAUSE TO BELIEVE, THAT THEY ARE DISQUALIFIED FROM DOING SO BY REASON OF THEIR IMMIGRATION STATUS. THOSE WHO EMPLOY AN ADULT WITHOUT LEAVE OR WHO IS SUBJECT TO CONDITIONS AS TO EMPLOYMENT WILL BE LIABLE TO A CIVIL PENALTY UNDER SECTION 15 OF THE IMMIGRATION, ASYLUM AND NATIONALITY ACT 2006 AND PURSUANT TO SECTION 21 OF THE SAME ACT, WILL BE COMMITTING AN OFFENCE WHERE THEY DO SO IN THE KNOWLEDGE, OR WITH REASONABLE CAUSE TO BELIEVE, THAT THE EMPLOYEE IS DISQUALIFIED.



Part 4 – Signatures (please read guidance note 11)

Signature of applicant or applicant’s solicitor or other duly authorised agent (see guidance note 12). **If signing on behalf of the applicant, please state in what capacity.**

Declaration	<ul style="list-style-type: none">• [Applicable to individual applicants only, including those in a partnership which is not a limited liability partnership] I understand I am not entitled to be issued with a licence if I do not have the entitlement to live and work in the UK (or if I am subject to a condition preventing me from doing work relating to the carrying on of a licensable activity) and that my licence will become invalid if I cease to be entitled to live and work in the UK (please read guidance note 15).• The DPS named in this application form is entitled to work in the UK (and is not subject to conditions preventing him or her from doing work relating to a licensable activity) and I have seen a copy of his or her proof of entitlement to work, or have conducted an online right to work check using the Home Office right to work checking service which confirmed their right to work (please see note 15)
Signature	  ON BEHALF OF DAVID DADDS
Date	09/12/2022
Capacity	Licensing Solicitor

For joint applications, signature of 2nd applicant or 2nd applicant’s solicitor or other authorised agent (please read guidance note 13). **If signing on behalf of the applicant, please state in what capacity.**

Signature	
Date	
Capacity	

Contact name (where not previously given) and postal address for correspondence associated with this application (please read guidance note 14) David Dadds Dadds LLP Licensing Solicitors 			
Post town		Postcode	

Telephone number (if any)	██████████
If you would prefer us to correspond with you by e-mail, your e-mail address (optional)	██████████

Notes for Guidance

1. Describe the premises, for example the type of premises, its general situation and layout and any other information which could be relevant to the licensing objectives. Where your application includes off-supplies of alcohol and you intend to provide a place for consumption of these off-supplies, you must include a description of where the place will be and its proximity to the premises.
2. In terms of specific regulated entertainments please note that:
 - Plays: no licence is required for performances between 08:00 and 23.00 on any day, provided that the audience does not exceed 500.
 - Films: no licence is required for 'not-for-profit' film exhibition held in community premises between 08.00 and 23.00 on any day provided that the audience does not exceed 500 and the organiser (a) gets consent to the screening from a person who is responsible for the premises; and (b) ensures that each such screening abides by age classification ratings.
 - Indoor sporting events: no licence is required for performances between 08.00 and 23.00 on any day, provided that the audience does not exceed 1000.
 - Boxing or Wrestling Entertainment: no licence is required for a contest, exhibition or display of Greco-Roman wrestling, or freestyle wrestling between 08.00 and 23.00 on any day, provided that the audience does not exceed 1000. Combined fighting sports – defined as a contest, exhibition or display which combines boxing or wrestling with one or more martial arts – are licensable as a boxing or wrestling entertainment rather than an indoor sporting event.
 - Live music: no licence permission is required for:
 - a performance of unamplified live music between 08.00 and 23.00 on any day, on any premises.
 - a performance of amplified live music between 08.00 and 23.00 on any day on premises authorised to sell alcohol for consumption on those premises, provided that the audience does not exceed 500.
 - a performance of amplified live music between 08.00 and 23.00 on any day, in a workplace that is not licensed to sell alcohol on those premises, provided that the audience does not exceed 500.
 - a performance of amplified live music between 08.00 and 23.00 on any day, in a church hall, village hall, community hall, or other similar community premises, that is not licensed by a premises licence to sell alcohol, provided that (a) the audience does not exceed 500, and (b) the organiser gets consent for the performance from a person who is responsible for the premises.
 - a performance of amplified live music between 08.00 and 23.00 on any day, at the non-residential premises of (i) a local authority, or (ii) a school, or (iii) a hospital, provided that (a) the audience does not exceed 500, and (b) the organiser gets

Appendix 1

The premises licence holder is a responsible operator who is aware of the 4 Licensing objectives, the Council's licensing policy and their responsibilities under the Licensing Act 2003. The business is run lawfully and in accordance with good business practice and offers the following conditions to be attached to the premises licence.

All health & safety, fire and other legal commitments will be complied with under the relevant legislation.

10. The premises shall install and maintain a comprehensive CCTV system as per the minimum requirements of a Metropolitan Police Crime Prevention Officer. All public areas and each entry and exit points will be covered enabling frontal identification of every person entering in any light condition. The CCTV system shall continually record whilst the premises is open for licensable activities and during all times when customers remain on the premises. All recordings shall be stored for a minimum period of 31 days with date and time stamping. Recordings shall be made available immediately upon the request of a Police or authorised officer.

11. There shall be a staff member from the premises who is conversant with the operation of the CCTV system on the premises at all times when the premises are open to the public. This staff member must be able to show a Police or authorised council officer recent data or footage when requested.

12. Premises to operate zero tolerance policy to drugs and comply with Hackney Police Drugs and Weapons policy where appropriate.

13. An incident log shall be kept at the premises, and made available on request to an authorised officer of the council or the police, which will record the following.

- a. All crimes reported:*
- b. All ejections of patrons*
- c. Any complaints received.*
- d. Any incidents of disorder.*
- e. Seizure of drugs or offensive weapons.*
- f. Any faults in the CCTV system.*
- g. Any visit by a relevant authority or emergency service.*

14. The Licensee shall ensure that all staff are fully trained and made aware of the legal requirement of businesses to comply with their responsibility as regards the disposal of waste produced from the business premises. The procedure for handling and preparing for disposal of the waste shall be in writing and displayed in a prominent place where it can be referred to at all times by staff.

15. There shall be no glass, or drinks in open containers taken outside of the premises at any time.

16. The Licensee shall ensure that any contract for general and recyclable waste disposal shall be appropriate in size to the amount of waste produced by the business. The Licensee shall maintain an adequate supply of waste receptacles provided by his registered waste carrier (refuse sacks or commercial waste bins) in order to ensure all refuse emanating from the business is always presented for collection by his waste carrier and shall not use any plain black or unidentifiable refuse sacks or any other unidentifiable or unmarked waste receptacles.

17. The Licensee's premises are situated in an area within which refuse may only be left on the public highway at certain times (time bands). If the Licensee's waste carrier cannot or does not comply by collecting the refuse within an hour after the close of any time band imposed by the waste authority, the Licensee must remove the refuse from the public highway and/or keep it within the premises until such time as their waste carrier arrives to collect the Refuse.

18. Clear prominent and legible signs should be erected asking customers to leave the area quietly; advising that CCTV system is operating and that police have unfettered access to it; and that management retain the right to search customers before permitting entry.

19. A written dispersal policy will be in place and implemented at the premises to move customers from the premises and the immediate vicinity in such a way as to cause minimum disturbance or nuisance to the neighbours.

20. Last entry to the premises shall be at midnight.

21. No unaccompanied children allowed on premises.

22. No children allowed inside the premises after 8 p.m.

31. A Challenge 25 proof of age scheme shall be operated at the premises where the only acceptable forms of identification are recognised photographic identification cards, such as a driving licence or passport.

Hart Hotel Lounge for Guests and Friends

Seating layout is for illustration purposes only - maximum capacity 120 people
No less than 90 people to be seated and no more than 30 people to be standing at any one time

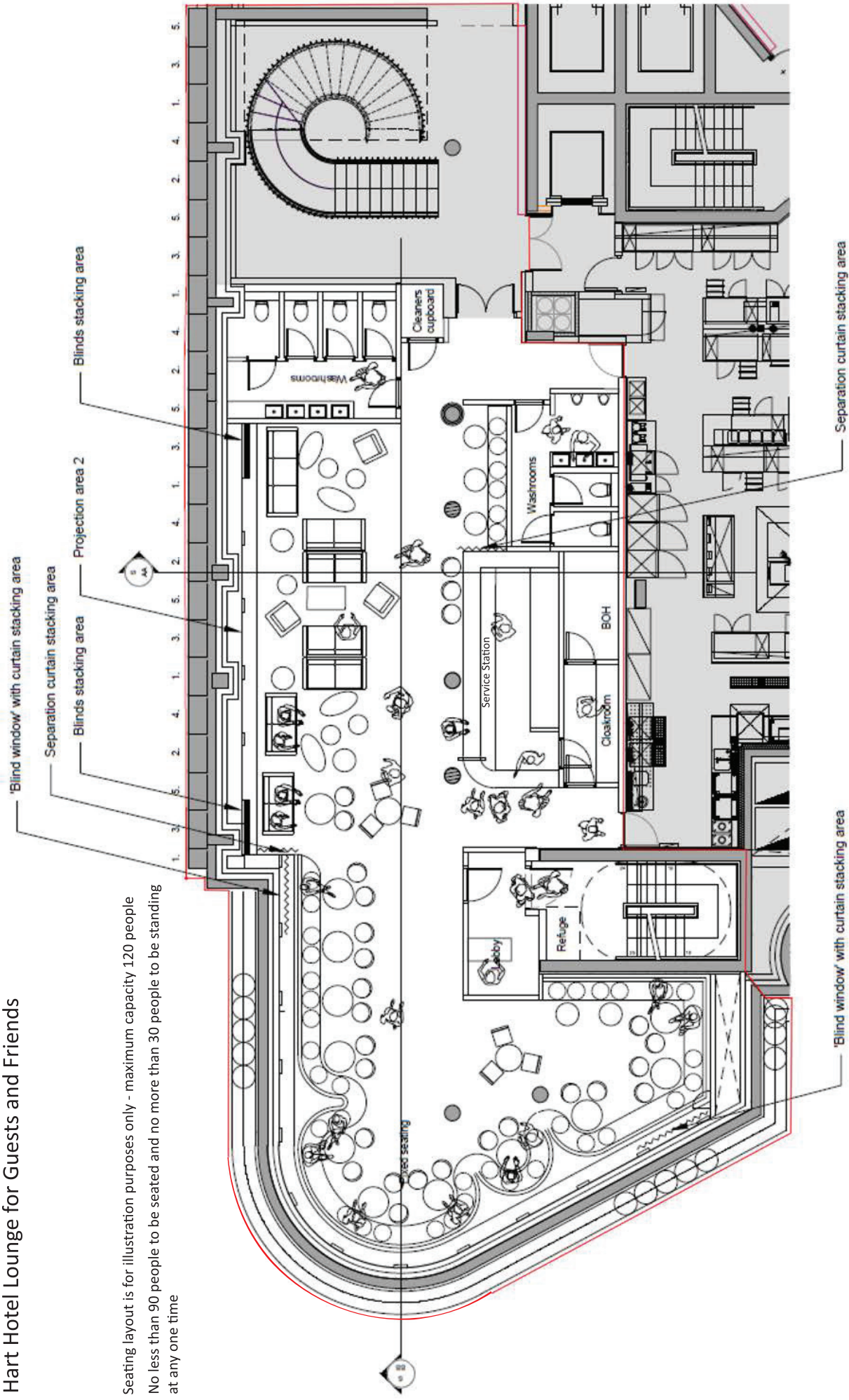

**RESPONSIBLE AUTHORITY REPRESENTATION:
APPLICATION UNDER THE LICENSING ACT 2003****RESPONSIBLE AUTHORITY DETAILS**

NAME OF AUTHORITY	London Borough of Hackney
ADDRESS OF AUTHORITY	Community Safety & Enforcement Service First Floor Hackney Service Centre 1 Hillman Street London E8 1DY
CONTACT NAME	Jacey Frewin
TELEPHONE NUMBER	020 8356 4567
E-MAIL ADDRESS	jacey.frewin@hackney.gov.uk

APPLICATION PREMISES

NAME & ADDRESS OF PREMISES	Hart (Hilton) Hotel Lounge For Guest and Friends Hotel 6A Ravey Street London EC2A 4QW
NAME OF APPLICANT	Shamal Overseas Shoreditch Limited t/a Hart (Hilton) Hotel

COMMENTS

I make the following relevant representations in relation to the above application to vary the Premises Licence at the above address. 1) the prevention of crime and disorder •

- 2) public safety •
- 3) the prevention of public nuisance **x**
- 4) the protection of children from harm •

ENVIRONMENTAL LICENCE CONDITIONS IN RESPECT OF

Hart (Hilton) Hotel Lounge for Guest and Friends Hotel

6a Ravey Street, London EC2A 4QW

1. The Licensee shall ensure that all relevant staff are fully trained and made aware of the legal requirement of businesses to comply with their responsibility as regards the disposal of waste produced from the business premises. The procedure for handling and preparing for disposal of the waste shall be in writing and displayed in a prominent place where it can be referred to at all times by staff.
2. The Licensee shall ensure that any contract for general and recyclable waste disposal shall be appropriate in size to the amount of waste produced by the business. The Licensee shall maintain an adequate supply of waste receptacles provided by his registered waste carrier (refuse sacks or commercial waste bins) in order to ensure all refuse emanating from the business is always presented for collection by his waste carrier and shall not use any plain black or unidentifiable refuse sacks or any other unidentifiable or unmarked waste receptacles.
3. In order to minimise the amount of time any waste remains on the public highway in readiness for collection, the Licensee will ensure the timeframe within which it may expect its waste carrier to collect is adhered to.
4. The Licensee shall instruct members of staff to make regular checks of the area immediately outside the premises and remove any litter, bottles and glasses emanating from the premises. A final check should be made at close of business.
5. The Licensee shall provide a safe receptacle for cigarette ends to be placed outside for the use of customers, such receptacles being carefully placed so as not to cause an obstruction or trip.
6. The current trade waste agreement/duty of care waste transfer document shall be conspicuously displayed and maintained in the window of the premises where it can be conveniently seen and read by persons standing in Hart (Hilton) Lounge. This should remain unobstructed at all times and should clearly identify:-
 - the name of the registered waste carrier
 - the date of commencement of trade waste contract
 - the date of expiry of trade waste contract
 - the days and times of collection
 - the type of waste including the European Waste Code

The above representations are supported by the following evidence and information.

We have received complaints in the past regarding littering and build-up of waste in the area. There have been instances in the past where Enforcement Officers have found evidence of the illegal disposal of waste from businesses in this area. Experience has also shown that there is the probability that there will be cigarette litter outside these premises due to the smoking ban.

Are there any actions or measures that could be taken to allay concerns or objections? If so, please explain.

contact Jacey Frewin by email

Name: Jacey Frewin

Date: 21/12/2022

**Planning Authority Representation:
Application under the Licensing Act 2003**

Details of Authority	1 Hillman Street, Hackney, London, E8 1FB
Officer contact name	Claudette Abraham
Officer telephone number	020 8356 4870
Officer's email address	claudette.abraham@hackney.gov.uk

APPLICATION PREMISES

Name and address of premises	Hart (Hilton) Hotel Lounge for Guest and Friends Hotel 6a Ravey Street London EC2A 4QW
Applicant name	Shamal Oversea Shoreditch Limited T/A Hart (Hilton) Hotel

COMMENTS

I make the following relevant representation in relation to the above application at the above address.

- Prevention of crime and disorder
- Public safety
- Prevention of public nuisance
- Protection of children from harm

Please supply any relevant evidence/information to support the above representation.

The application proposes for a new premises licence as a hotel the area to be licensed is a guest and field lounge with a maximum capacity of 120 guests, the area has been created to enhance the experience of the guests. It is predominantly seated with water service normally seating no more than 30 guests standing under the Licensing Act 2003.

The licensable activities are:

The application is for a new premises licence as a pub under the licensing act 2003. The licensable activities are:

Performance of Dance Mon-Sun 08:00-02:00

Plays Mon-Sun 08:00-02:00

Films Mon-Sun 08:00-02:00

Live Music Mon-Sun 08:00-02:00

Recorded Music Mon-Sun 08:00-02:00

Late night Refreshment Mon-Sun 23:00-02:00

Supply of Alcohol Mon-Sun 08:00-02:00

Hours of Opening Mon-Sun 08:00-02:30

No record could be found for the approval for the use of the premises as a hotel. Therefore the applicant is advised that planning permission may be required for the usage of the premises. Operation of the premises without appropriate planning permission is unlawful and may result in enforcement action.

No representation with informatives

Please provide the following information (if applicable)

Area (that permission applies to)	N/A
Permitted use	Unknown
Permitted hours	N/A
Specific/restrictive conditions	N/A
Recent applications	N/A
Decisions	N/A
Pending Decisions	N/A
Reasons for refusal	N/A
Relevant Conditions/discharges	N/A

Are there any actions or measures that could be taken to allay concerns or objections? If so, please explain.

No representation with Informatives

The applicant is advised that these comments do not represent a formal decision of the Local Planning Authority as to the acceptability or otherwise of the proposed use and that the decision of the Licensing Authority is not prejudicial to the determination of any subsequent planning application.

Signed	Gareth Barnett
Name	
Date	01. 01.2023

APPENDIX B3

RESPONSIBLE AUTHORITY REPRESENTATION: APPLICATION UNDER THE LICENSING ACT 2003

RESPONSIBLE AUTHORITY DETAILS

NAME OF AUTHORITY	Metropolitan Police service
ADDRESS OF AUTHORITY	Licensing Unit, Stoke Police Station 33 Stoke Newington High Street London N16 8DS
CONTACT NAME	PC 3288CE Amanda GRIGGS
TELEPHONE NUMBER	07884 561085
E-MAIL ADDRESS	hackneylicensing@met.police.uk

APPLICATION PREMISES

NAME & ADDRESS OF PREMISES	Hart (Hilton) Hotel Lounge for Guests and Friends 6a Ravey Street London EC2A 4QW
NAME OF PREMISES USER	Shamal Overseas Shoreditch Ltd T/A Hart (Hilton) Hotel

COMMENTS

I make the following relevant representations in relation to the above application for a Premises Licence at the above address.

- 1) the prevention of crime and disorder ◆
- 2) public safety □
- 3) the prevention of public nuisance ◆
- 4) the protection of children from harm □

Representations (which include comments and/or objections) in relation to:

Police make the following representations in relation to the application for a Premises Licence at Hart (Hilton) Hotel Lounge for Guests and Friends, 6a Ravey Street, EC2A 4QW for the following reason(s);

The premises name is that it is a Hotel Lounge for Guest and Friends, however throughout the operating schedule and the application there is no mention whether these are the only people that will be allowed entry to the venue. From the address given it does not appear to be connected to the hotel therefore police would like to know how the venue plans to operate.

Will members of the public be allowed access to the lounge? If not how will entry be monitored?

A visit to the premises would assist police with the above concerns.

There is mention of a dispersal policy in the operating schedule. Could police please be provided with a copy?

The plan and description of the venue quote figures of a minimum of 90 people seated and a maximum of 30 people standing – would the applicant be happy to have a condition based on these figures?

The venue is situated in the Shoreditch SPA, however there is no mention in the application or operating schedule of this, or how the venue will not add to the cumulative impact on the area. As per LP10 of the Councils Licensing Policy, if the applicant can demonstrate this, then core hours would apply. Core Hours are given in LP3 of the Licensing Policy. This application requests hours that are outside these and yet again there have been no measures in place to assist in mitigating the potential impact of them.

The above representations are supported by the following evidence and information.

Personal knowledge of the local area and issues in the area.

Are there any actions or measures that could be taken to allay concerns or objections? If so, please explain.

Visit to the premises, reduction in hours, conditions to assist in mitigating any impact.

Signed
PC 3288CE GRIGGS
(By E-mail)
Name (printed)

APPENDIX B4

RESPONSIBLE AUTHORITY REPRESENTATION: APPLICATION UNDER THE LICENSING ACT 2003

RESPONSIBLE AUTHORITY DETAILS

NAME OF AUTHORITY	Licensing Authority
ADDRESS OF AUTHORITY	Licensing Service 1 Hillman Street London E8 1FB
CONTACT NAME	Channing Riviere
TELEPHONE NUMBER	020 8356 4622
E-MAIL ADDRESS	Channing.riviere@hackney.gov.uk

APPLICATION PREMISES

NAME & ADDRESS OF PREMISES	The Edge Shoreditch 6A Ravey Street Hackney London EC2A 4QW
NAME OF APPLICANT	Shamal Overseas Shoreditch Ltd.

COMMENTS

I make the following relevant representations in relation to the above application.

- the prevention of crime and disorder
- public safety
- the prevention of public nuisance **x**
- the protection of children from harm

Representations (which include comments and/or objections) in relation to:

The premises is located in the Shoreditch Special Policy Area (Shoreditch SPA), the Shoreditch SPA has been designated as such due to the impact of the number of premises within the area and their impact on the licensing objectives as well as the local amenity.

“LP10 Special Policy Areas – Dalston and Shoreditch

It is the Council’s policy that where a relevant representation is made to any application within the area of the Dalston SPA or Shoreditch SPA, the applicant will need to demonstrate that the proposed activity and the operation of the premises will not add to the cumulative impact that is currently being experienced in these areas. This policy is to be strictly applied.

It should also be noted that the;

- *quality and track record of the management;*
- *good character of the applicant; and*
- *extent of any variation sought*

May not be in itself sufficient.

It should be noted that if an applicant can demonstrate that they will not add to the cumulative impact in their operating schedule and at any hearing, then the Core Hours Policy within LP3 will apply.”

It should be noted that the premises related to this application are already licensed albeit via a different address. The size of the site has enabled the applicant to submit the application with a different address; however, the Plan submitted and the Plan attached to the existing licence are virtually identical. The Licensing sub-committee decision for the existing licence has been appended to this representation.

The Licensing Authority notes that if the applicant is seeking to operate until 02:30 within the Shoreditch SPA, there is potential that the Prevention of Public Nuisance Licensing objective may be undermined.

The Licensing Authority also notes that the applicant has offered a last entry condition at midnight.

The above representations are supported by the following evidence and information.

The Licensing Act 2003, Statement of Licensing Policy 2016 and Guidance issued by the Home Office.

Are there any actions or measures that could be taken to allay concerns or objections? If so, please explain.

N/A

Name: Channing Riviere (Principal Licensing Officer)

Date: 06/01/2023

Application for a Premises Licence – BYRD, 61/67 Great Eastern Street, London, EC2A 3HU – APPROVAL

The decision of 14th October 2021

The Licensing Sub-Committee in considering this decision from the information presented to it within the report and at the hearing today has determined that having regard to the promotion of all the licensing objectives:

- The prevention of crime and disorder;
- Public safety;
- Prevention of public nuisance; and
- The protection of children from harm,

the application for a premises licence has been approved in accordance with the Council's Statement of Licensing Policy and the proposed conditions set out in paragraph 8.1 of the report, with the following amendments:

- The hours for licensable activity are:

The opening hours of the premises:

Monday - Thursday	08:00 - 23:30
Friday - Saturday	08:00 - 00:30
Sunday	08:00 - 23:00

Plays

Monday - Thursday	08:00 - 23:00
Friday - Saturday	08:00 - 00:00
Sunday	10:00 - 22:30

Film

Monday - Thursday	08:00 - 23:00
Friday - Saturday	08:00 - 00:00
Sunday	10:00 - 22:30

Live Music

Monday - Thursday	08:00 - 23:00
Friday - Saturday	08:00 - 00:00
Sunday	10:00 - 22:30

Recorded Music

Monday - Thursday	08:00 - 23:00
Friday - Saturday	08:00 - 00:00
Sunday	10:00 - 22:30

Performance of Dance

Monday - Thursday	08:00 - 23:00
Friday - Saturday	08:00 - 00:00
Sunday	10:00 - 22:30

Late Night Refreshment

Friday - Saturday	23:00 - 00:00
-------------------	---------------

Supply of Alcohol (on sales):

Monday - Thursday	08:00 - 23:00
Friday - Saturday	08:00 - 00:00
Sunday	10:00 - 22:30

- Remove conditions 14 and 23 from the licence.
- Condition 24 shall be amended and read as follows:

“The number of people that will be using the designated smoking area (opposite main entrance to BYRD on Ravey Street and Willow Street) is limited to 8 people at any one time before 22:00 and shall be monitored by staff”.

And the following additional condition:

- From 20:00 the sale of alcohol shall be ancillary to a substantial table meal.
- From 22:00 the maximum number of persons allowed on the premises at any one time shall not exceed 136 persons (excluding staff)

Reasons for the decision

The application for a premises licence has been approved, because members of the Licensing sub-committee were satisfied that the licensing objectives would not be undermined within the Shoreditch Special Policy Area (Shoreditch SPA).

The sub-committee took into account that the Responsible Authorities (Environmental Enforcement and Environmental Protection) agreed conditions with the applicant and withdrew their objections in advance of the hearing. The Metropolitan Police Service also agreed conditions and reduced hours with the applicant and subsequently withdrew their objections in advance of the hearing. It was noted that there were no objections raised by local residents.

The sub-committee took into consideration the representations made by the Licensing Authority, and their concerns about the impact on the Shoreditch SPA which suffered from public nuisance and the cumulative impact in the area. However, the Licensing Authority was happy with the reduced hours. It was noted that the Police had concerns about another premises in the Shoreditch SPA.

The sub-committee also took into consideration that the premises is located in the Shoreditch SPA and therefore it is subject to policy LP10.

The sub-committee heard submissions from the applicant's representative that the applicant is aware of the nature and location of the premises because they had worked in the hotel as a manager for sometime, and they intended to operate the premises responsibly and within core hours.

The sub-committee took into consideration that the premises is on the edge of Shoreditch SPA, however, the impact will be minimal and it may improve the area. The sub-committee took into account that the premises are separate from the hotel. It was noted that all licensable activities carried out after 20:00 will be ancillary to the use of the restaurant for fine dining.

The sub-committee after hearing from the applicant, the applicant's representative, and the Licensing Authority were satisfied that the premises would not add to the cumulative impact in the area, and would not threaten the licensing objectives in the Shoreditch SPA. The sub-committee took into consideration the nature of the business, and that it will operate under core hours in accordance with Policy LP3. The sub-committee noted it was a food led premises and that the alcohol will be served ancillary to a substantial meal. The sub-committee also took into consideration the conditions agreed with the Responsible Authorities that would help overcome any negative impact in the Shoreditch SPA.

Having taken all of the above factors into consideration, the sub-committee were satisfied that by granting this premises licence, the licensing objectives would continue to be promoted within the Shoreditch SPA.

APPENDIX C

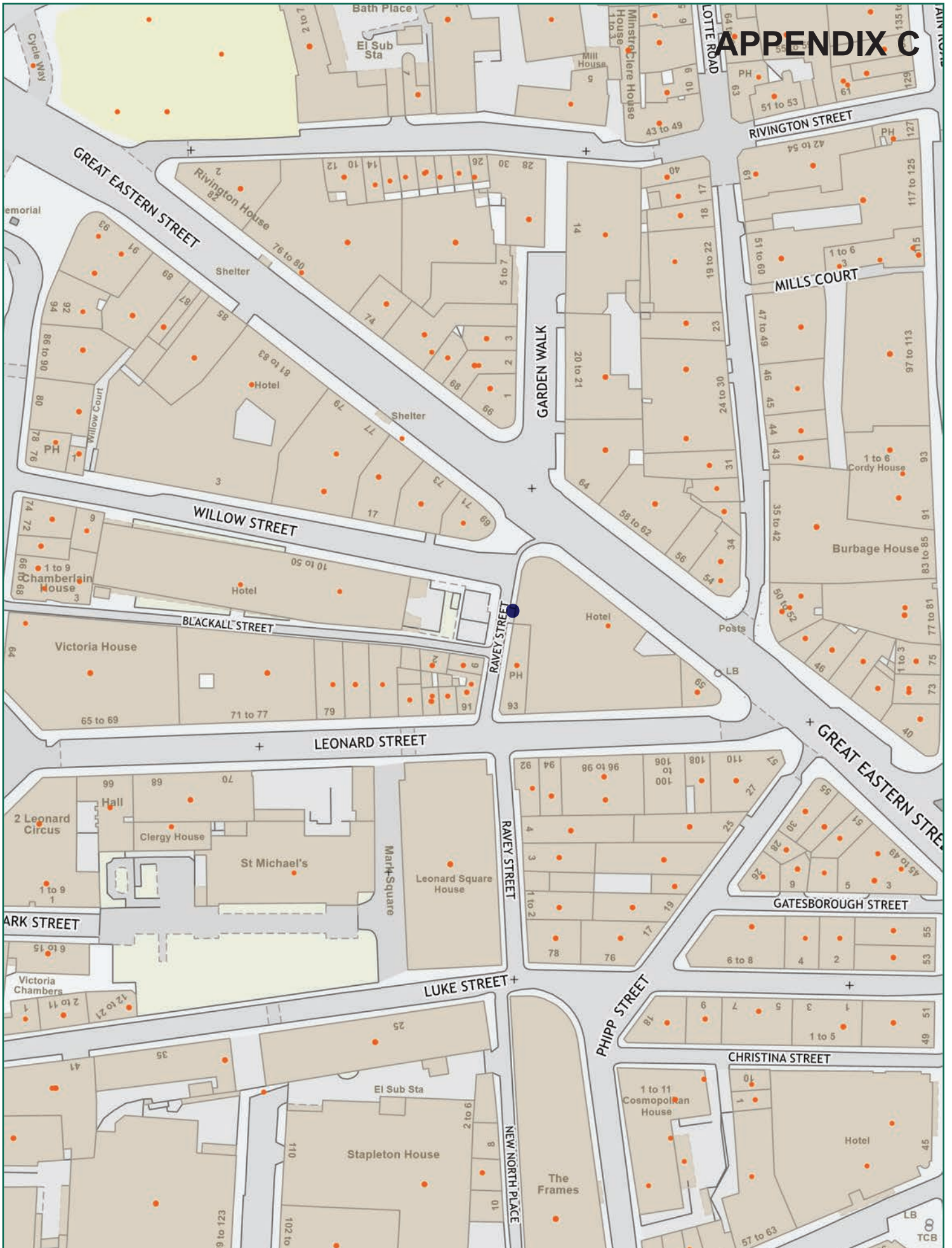

Scale: 1:1250 at A4

Hart (Hilton) Hotel Lounge for Guest and Friends Hotel, 6a Ravey Street, EC2A 4QW



Ref:
Tuesday, February 7, 2023

Produced by: unspecified
email:

please specify copyright statement